

STARLINK

|

STANDARD TO STANDARD ACTUATED MOUNT ADAPTER
INSTALL GUIDE

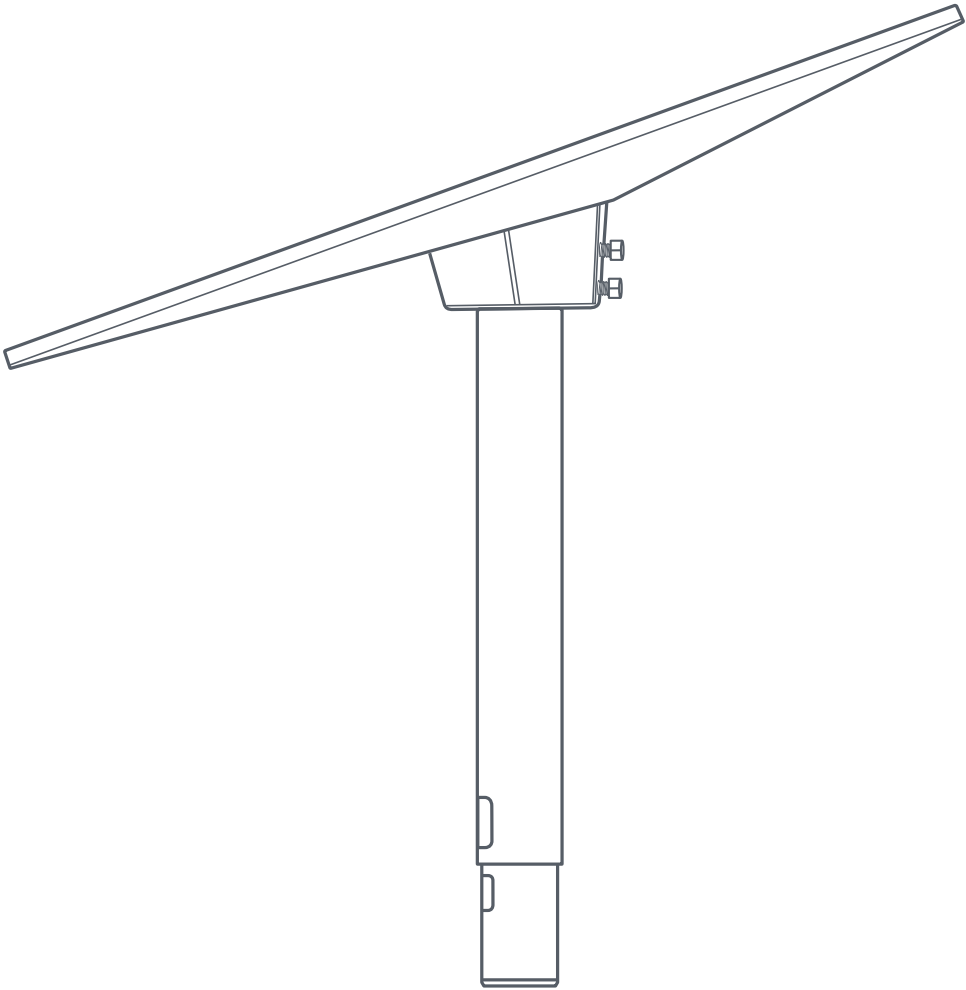

What's in the Box

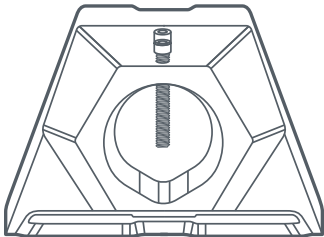

Pipe Adapter



Mast Tube



Hex Key

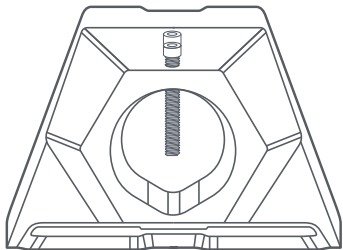

31 mm - 63 mm
(1.25 in - 2.5 in)

38.1 mm
(1.5 in)



231 mm
(9.09 in)

558 mm
(21.96 in)

213 mm
(8.38 in)

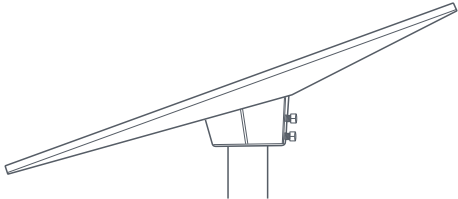

1 | Download the Starlink App

Scan the QR code to download the Starlink App.

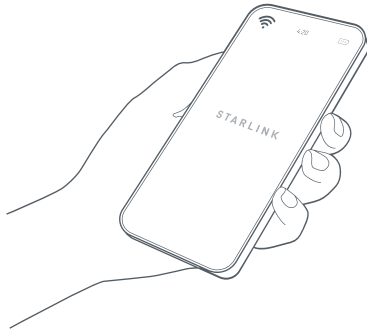

2 | Find Mounting Location

Your Starlink needs a clear view of the sky so it can stay connected with satellites as they move overhead. Objects that obstruct the connection between your Starlink and the satellite, such as a tree branch, pole, or roof, will cause service interruptions. Use the obstruction tool in the App to ensure you have selected a suitable mounting location.

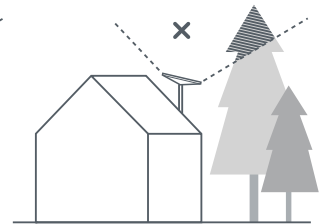
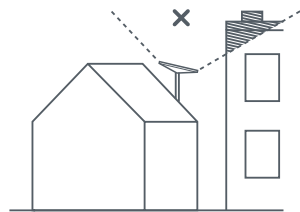
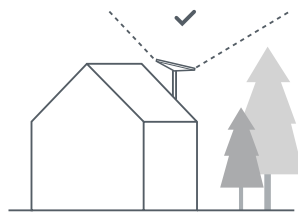
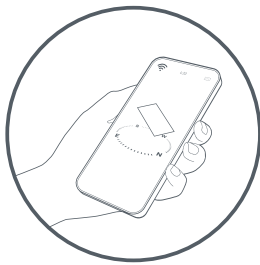

3 | Remove Kickstand

Squeeze the release tab and pull it away from its fixed location.

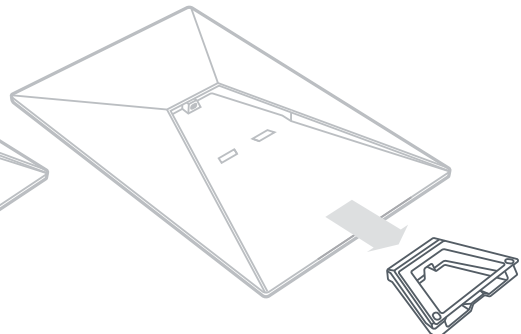
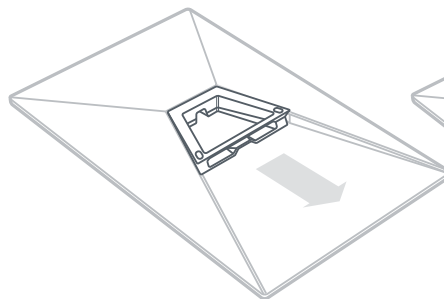

4 | **Route Cable Through Pipe Adapter**

Route the Starlink cable through the opening in the pipe adapter and out the front end.

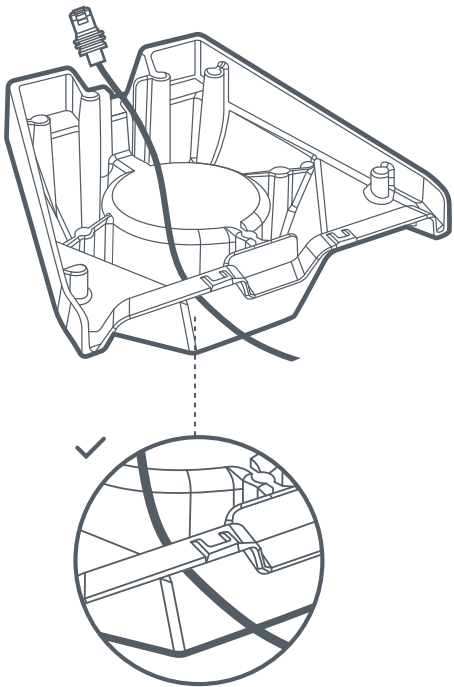

5 | **Plug in Cable and Install Pipe Adapter**

Plug the cable into your Starlink.

Ensure the plug is fully inserted such that the plug face is flush with the surface.

Next, slide the adapter in until it clicks into place.

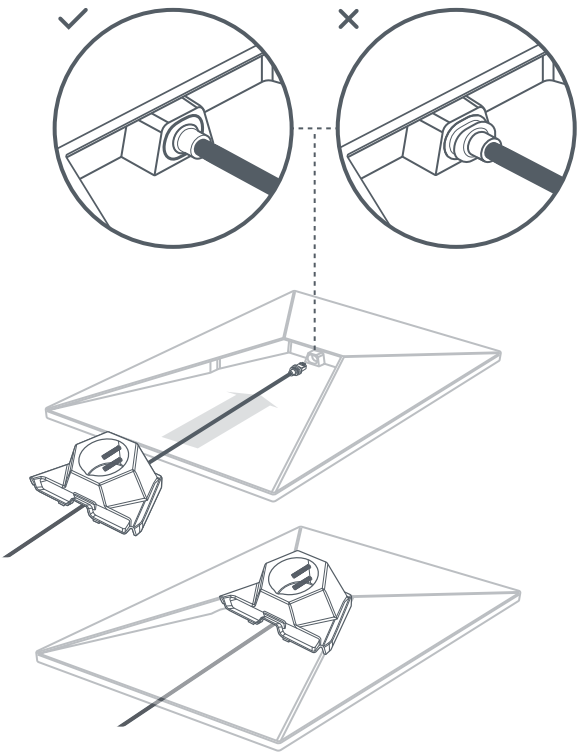

6 | Mount Starlink

Loosen the screws and slide the Pipe Adapter onto your mast tube. Temporarily tighten the screws to stabilize Starlink onto tube.

Connect the other end of the Starlink cable to router and plug in router power.

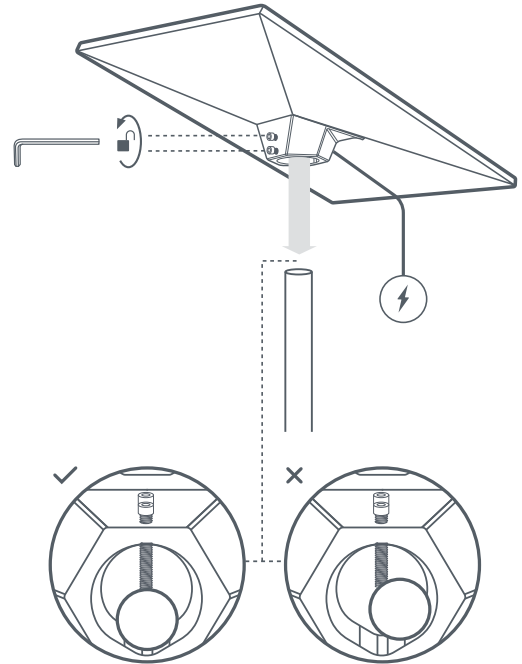

7 | Install Starlink into Mount

Slide the mast into your existing Standard Actuated Mount.

The Standard Adapter Mount is compatible with Starlink Standard Actuated Mounts: Short Wall Mount, Long Wall Mount, Pivot Mount, Ground Pole Mount, Ridgeline Mount.

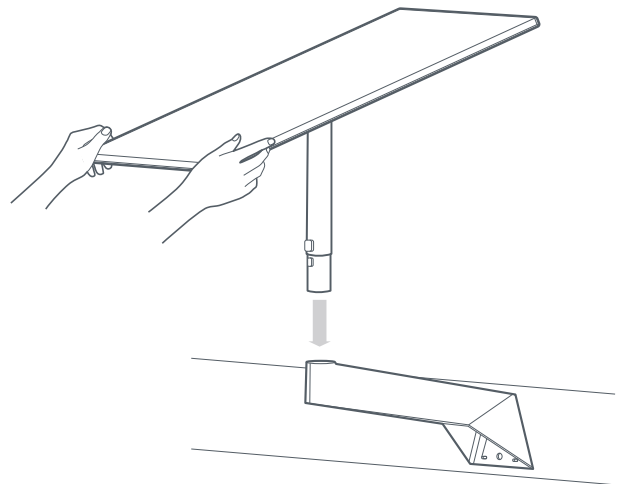

8 | Align and Lock Your Starlink

An alert on the App will show if you need to rotate Starlink to be properly aligned. Click the alert to use the alignment tool.

Tighten the screws on the Pipe Adapter to lock your Starlink in place. Ensure your Starlink is firmly attached.

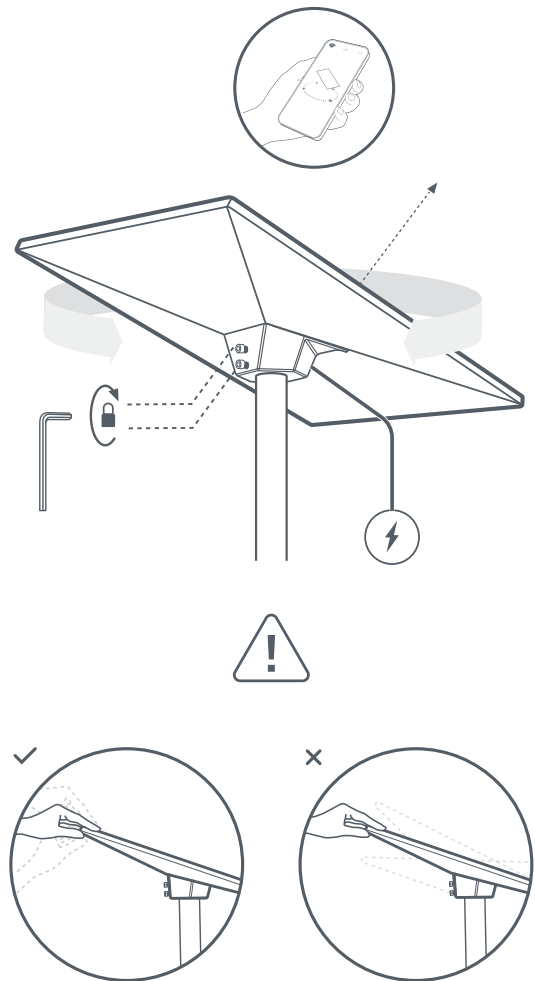

INSTALLATION CONDITIONS

⚠️**CAUTION!** If you are uncomfortable with any part of the installation process, do not attempt - contact a professional to install your Starlink. Starlink is not responsible for injury or damage to property caused by the installation process.

Kit Installation for Use on Moving Vehicles.

⚠️**CAUTION!** Take extra care if installing a Starlink for being used on a moving vehicle or vessel. Ensure that the mount is installed firmly on a structurally sound, horizontal surface away from other equipment to give your Starlink a clear view of the sky. Equipment falling off the vehicle due to poor installation practices can cause serious accidents resulting in bodily injury, do not mount the Starlink on any vehicle or vessel if the mount structure is not stable, or if it cannot be properly secured as described in this guide. Ensure the installation on vehicle or vessel is compliant with local Department of Transportation or maritime regulations.

⚠️**WARNING!** Mounts are not designed for high winds, hurricane or tornado wind loads. Tethering should be used in all cases to prevent failure in an unexpected wind event. See installation instructions before connecting this equipment to the input supply.

⚠️**WARNING!** To avoid personal injury and/or damage to the property when drilling, take caution and follow basic safety procedures, including:

- Wear appropriate eye, hand, and face protection.
- Avoid studs, electrical wiring, and water lines when drilling. Drilling into any of these can lead to fire, shock, injury, or death.
- Drill at a slight downward angle from the home interior to the home exterior and thoroughly apply sealant. Improper drilling and sealing may lead to water and/or bug intrusion and/or damage.