

STARLINK | POWER SUPPLY MOUNT INSTALL GUIDE

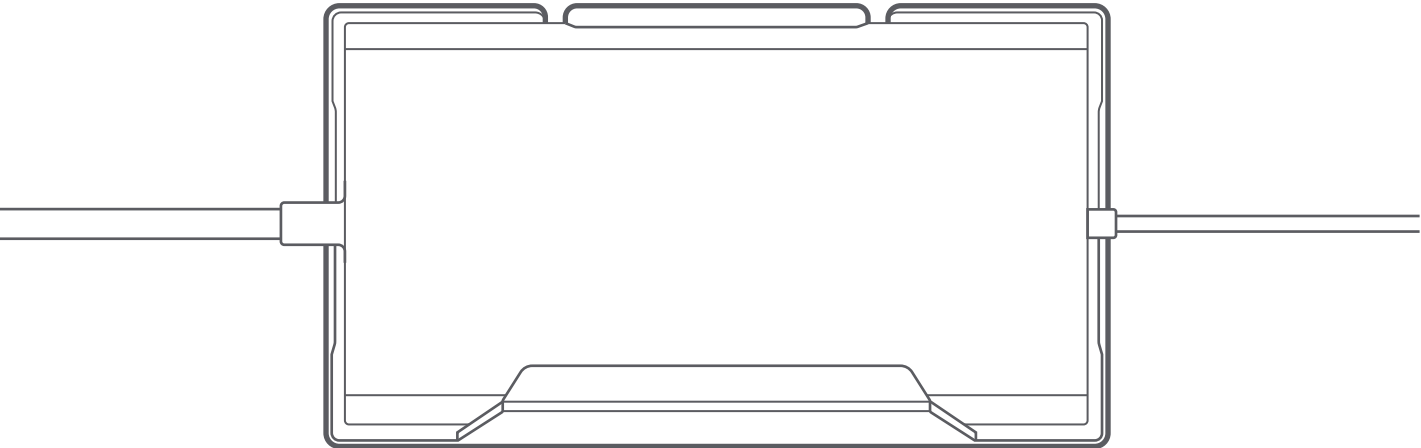

What's in the Box

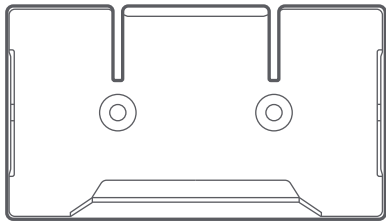

Power Supply Mount



Screws
2x



Wall Anchors
2x

Recommended Tools

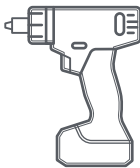

Drill / Impact Driver



Drill Bit
4 mm (5/32 in)
No Anchors



Drill Bit
7 mm (9/32 in)
With Anchors



#2 Phillips
Screwdriver



Marker



Level

102.4 mm
(4 in)

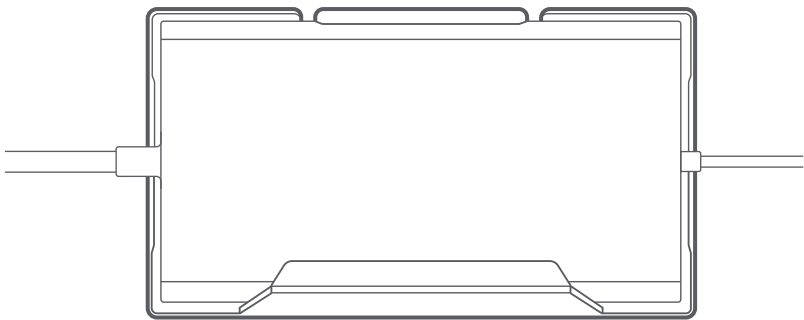

181 mm
(7.13 in)

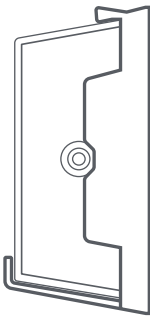

48.75 mm
(1.92 in)

NON-ANCHOR INSTALLATION

1 | Mark and Drill Mounting Holes

Use the mount as a guide to mark the hole locations, then drill using a 4mm (5/32 in) diameter drill bit if not using the provided drywall anchors

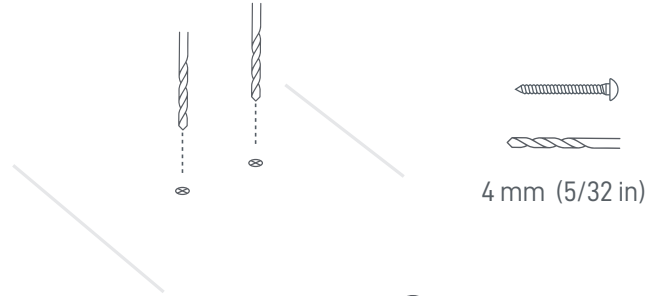

2 | Screw Mount to Surface

Secure the mount using the provided screws.

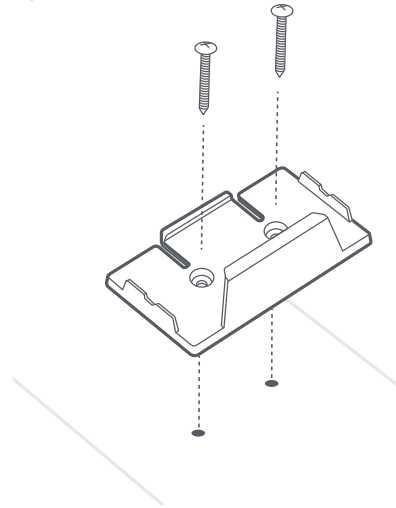

3 | Plug in Power Supply

Plug the power cable into the power supply.

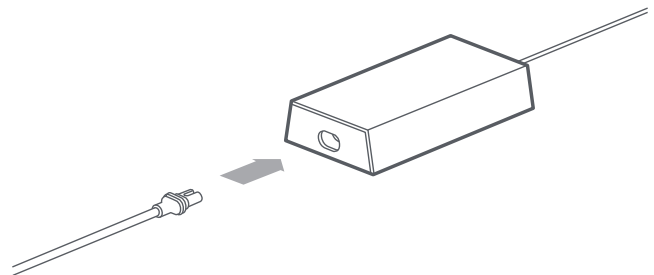

4 | Snap the Power Supply into Mount

Fit the bottom edge of the router into the mount, then press the router into the mount until it clicks into place.

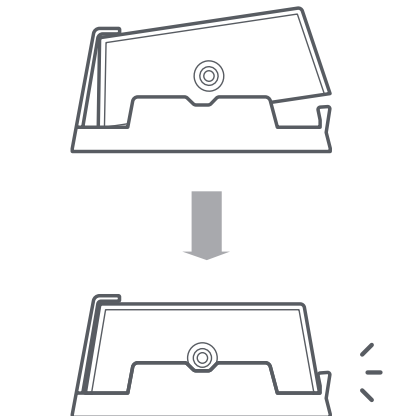

ANCHOR INSTALLATION

1 | Mark and Drill Mounting Holes

Use the mount as a guide to mark the hole locations, then drill using a 7mm (9/32 in) diameter drill bit if intending to use the provided drywall anchors.

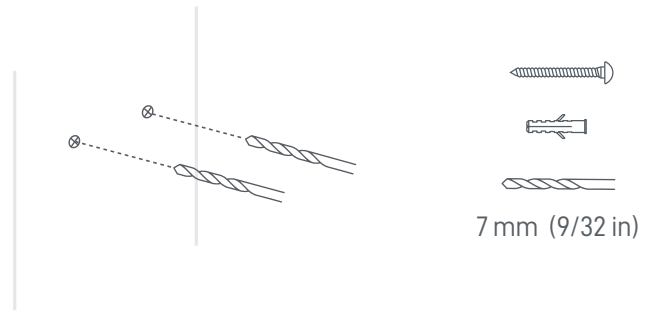

2 | Screw Mount to Surface

Install the drywall anchors into the holes, then secure the mount using the provided screws.

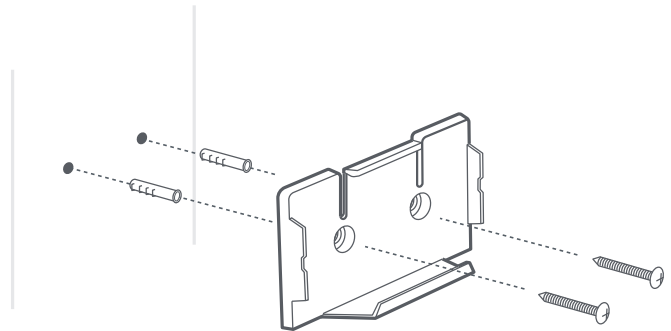

3 | Plug in Power Supply

Plug the power cable into the power supply.

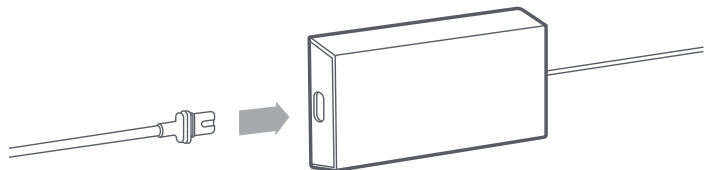

4 | Snap the Power Supply into Mount

Fit the bottom edge of the router into the mount, then press the router into the mount until it clicks into place.

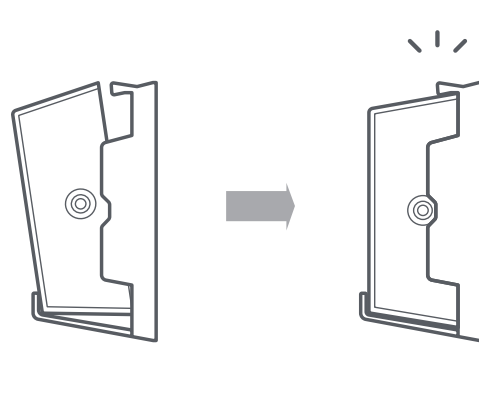

INSTALLATION CONDITIONS

⚠**CAUTION!** If you are uncomfortable with any part of the installation process, do not attempt - contact a professional to install your Starlink. Starlink is not responsible for injury or damage to property caused by the installation process.

Kit Installation for Use on Moving Vehicles.

⚠**CAUTION!** Take extra care if installing a Starlink for being used on a moving vehicle or vessel. Ensure that the mount is installed firmly on a structurally sound, horizontal surface away from other equipment to give your Starlink a clear view of the sky. Equipment falling off the vehicle due to poor installation practices can cause serious accidents resulting in bodily injury, do not mount the Starlink on any vehicle or vessel if the mount structure is not stable, or if it cannot be properly secured as described in this guide. Ensure the installation on vehicle or vessel is compliant with local Department of Transportation or maritime regulations.

⚠**WARNING!** Mounts are not designed for high winds, hurricane or tornado wind loads. Tethering should be used in all cases to prevent failure in an unexpected wind event. See installation instructions before connecting this equipment to the input supply.

⚠**WARNING!** To avoid personal injury and/or damage to the property when drilling, take caution and follow basic safety procedures, including:

- Wear appropriate eye, hand, and face protection.
- Avoid studs, electrical wiring, and water lines when drilling. Drilling into any of these can lead to fire, shock, injury, or death.
- Drill at a slight downward angle from the home interior to the home exterior and thoroughly apply sealant. Improper drilling and sealing may lead to water and/or bug intrusion and/or damage.