

STARLINK | PERFORMANCE WALL MOUNT

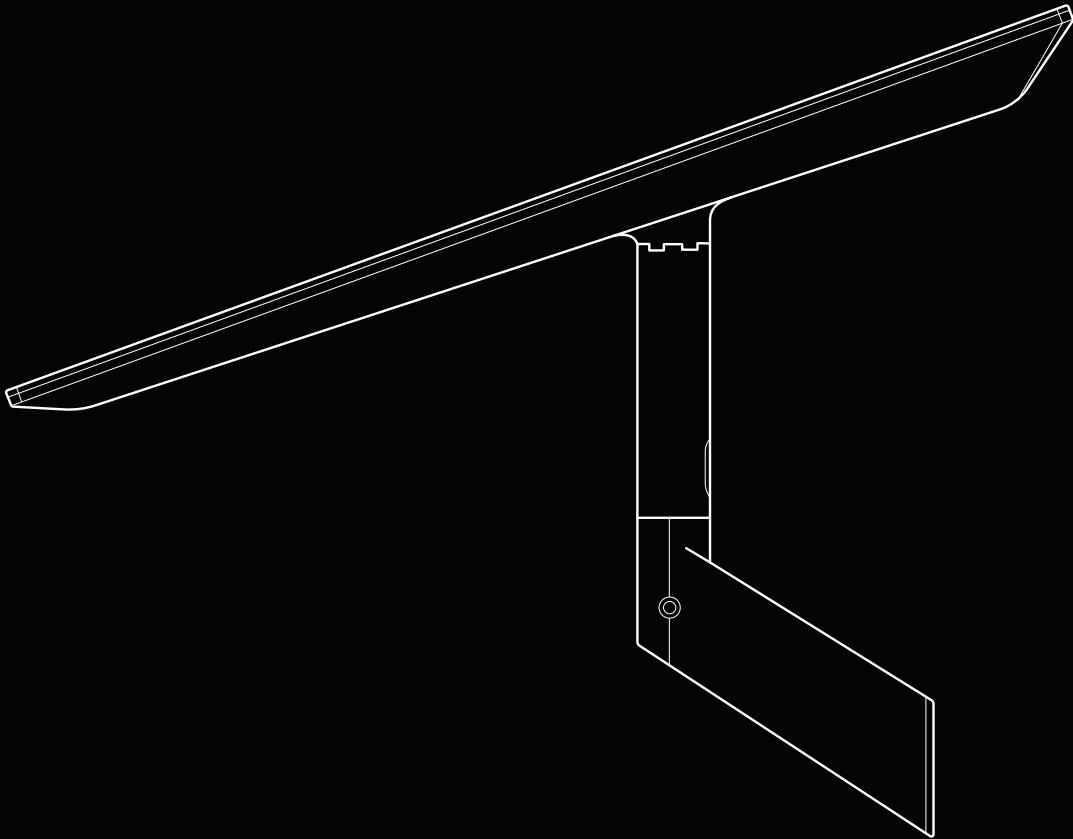

What's in the Box

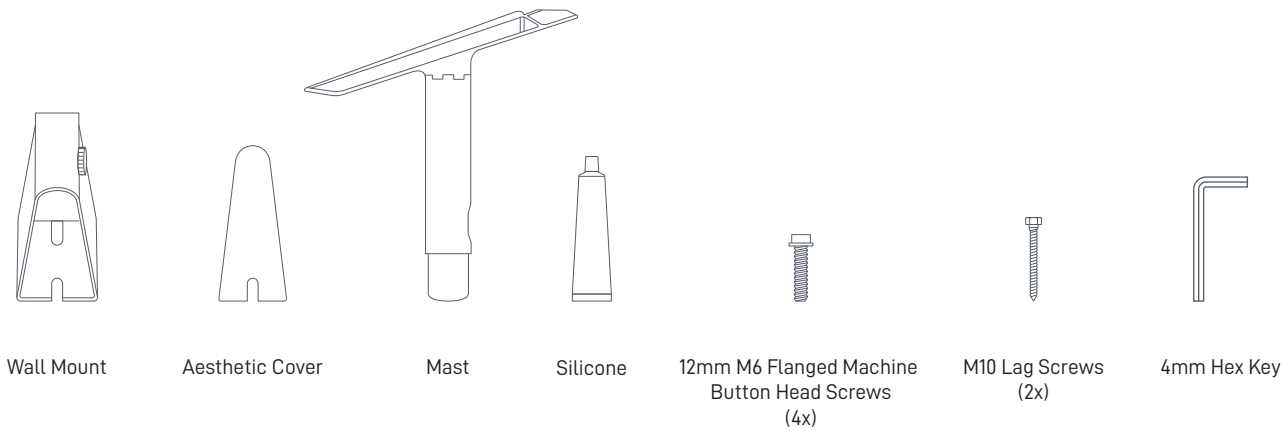

Recommended Tools

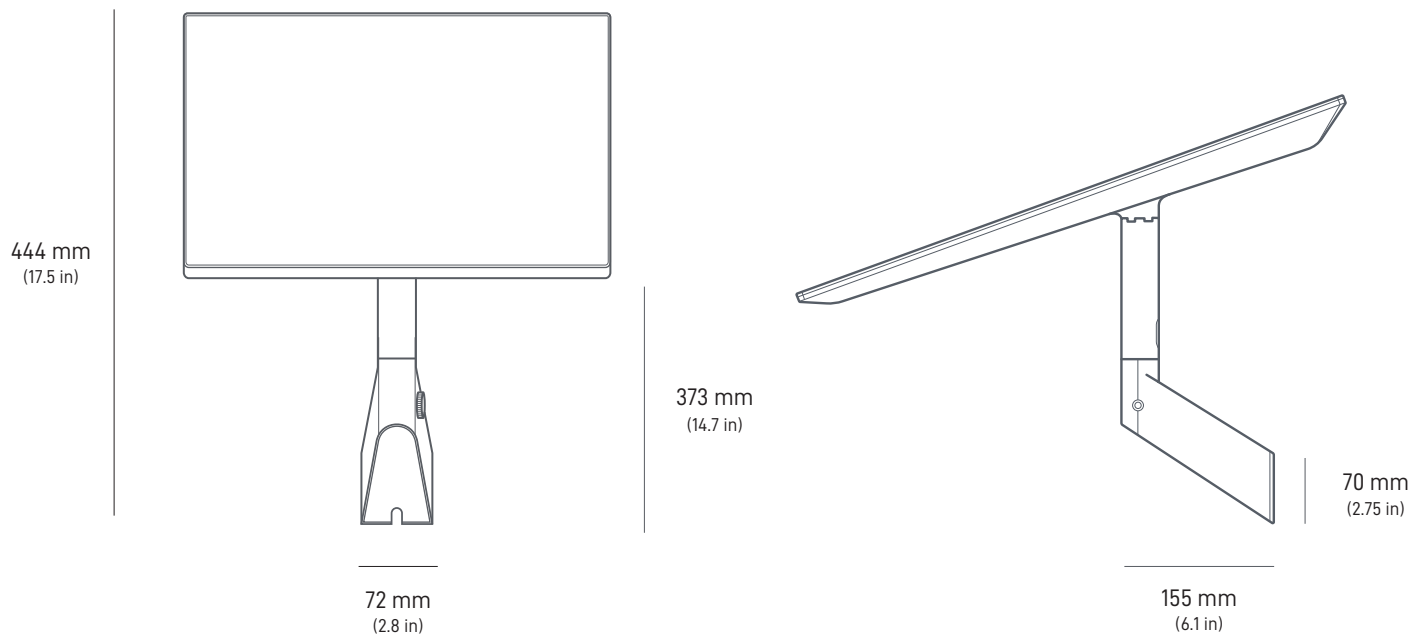
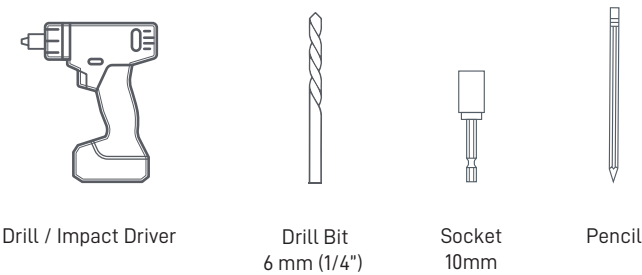

1 | **Download the Starlink App**

Scan the QR code to download the Starlink App.

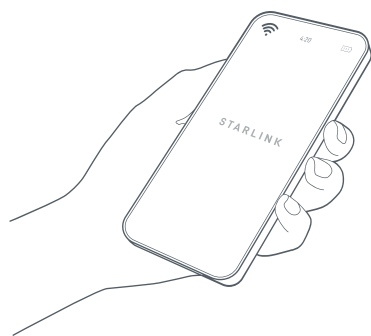

2 | **Find a mounting location**

Your Starlink needs a clear view of the sky so it can stay connected with satellites as they move overhead. Objects that obstruct the connection between your Starlink and the satellite, such as a tree branch, pole, or roof, will cause service interruptions. Use the obstruction tool in the App to ensure you have selected a suitable mounting location.

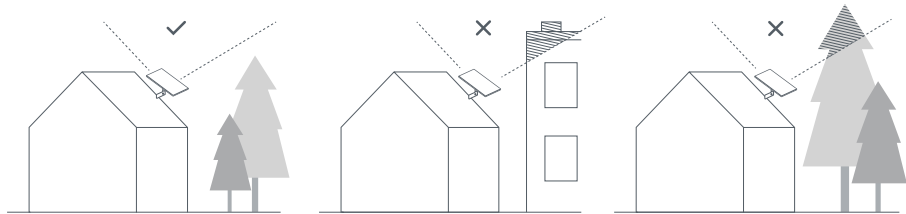
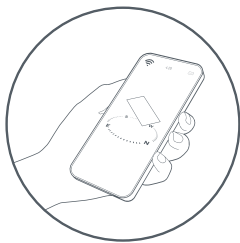

3 | **Install with Clearance to Structures**

Ensure the mounting location provides enough clearance for your Starlink, which may need to rotate to be properly aligned.

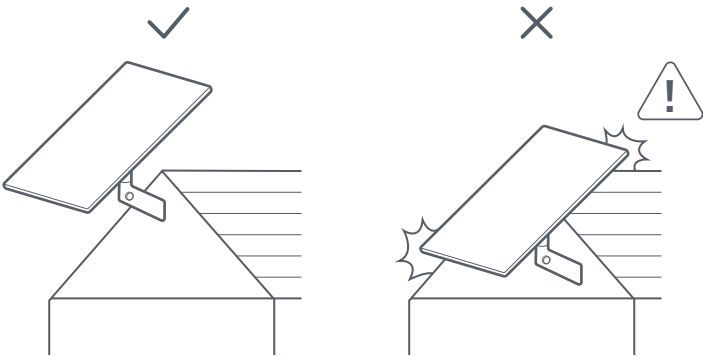

4 | **Route Cable Through Mount**

Insert the Performance Connector end of the Starlink cable through the hole in the side of the mast and up through the slot in the adapter.

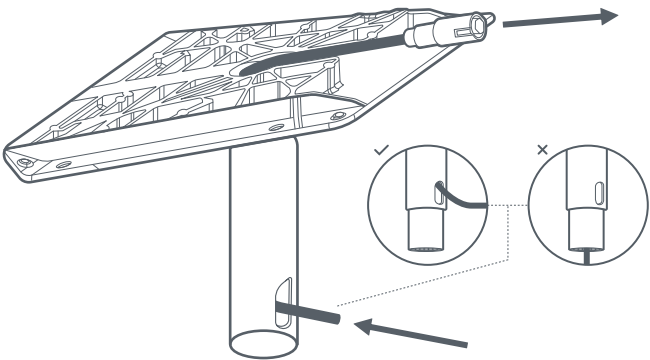

5 | Plug in Starlink Cable

Align the Performance Connector end of the Starlink cable indicated by the red notch and plug into your Starlink by holding the end of the plug and firmly inserting into the dish.

If the Starlink cable needs to be removed, rotate the collar counterclockwise and pull to disconnect from your Starlink.

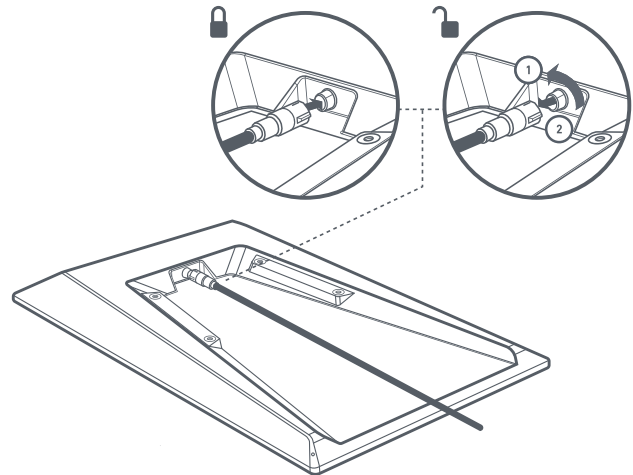

6 | Install Wall Mount Onto Starlink

Install the provided machine screws through the wall mount into the back of the Starlink and tighten the four screws using the hex key. Tighten screws in all 4 corners until bolts reach 7 N-m (5.2 lb-ft). Ensure the mount is firmly attached to the Starlink.

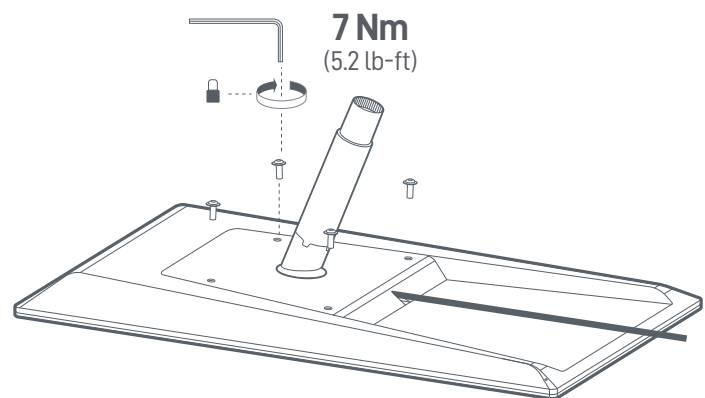

7 | Mark the Pilot Holes

Mark the location of the two holes on your wall mount using a marker. Place the holes directly over a structural beam to best secure your Starlink.

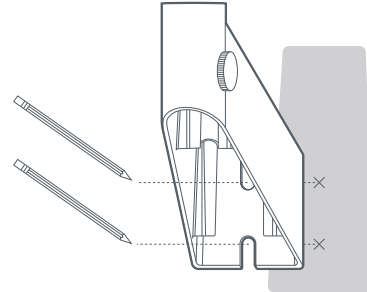

8 | Drill the Pilot Holes

Drill the holes with a 6 mm (1/4 in) drill bit.

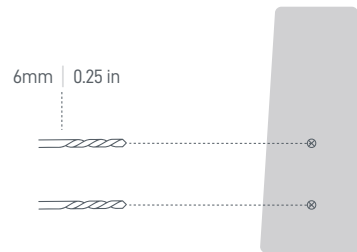

9 | Apply Sealant and Screw in Wall Mount

Apply silicone inside and over the holes. Screw in the mount using the provided screws.

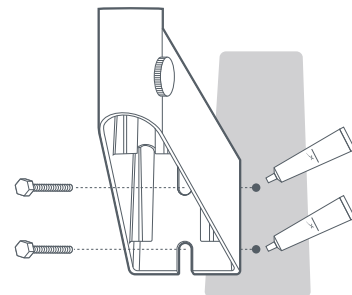

10 | Insert Starlink into Wall Mount

Slide the mast into the wall mount. Rotate your Starlink to face a clear view of the sky.

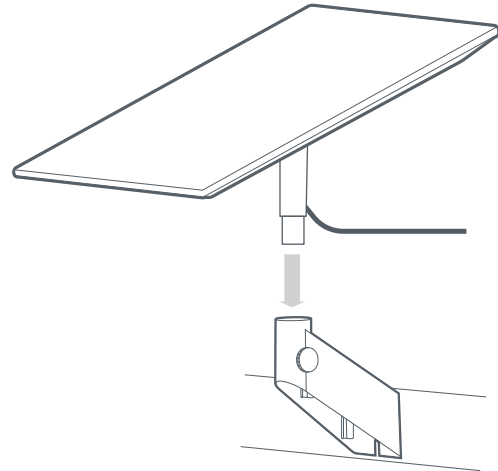

11 | Feed Cable Through Wall Mount

Feed the Starlink cable through the hole in the top side of the wall mount.

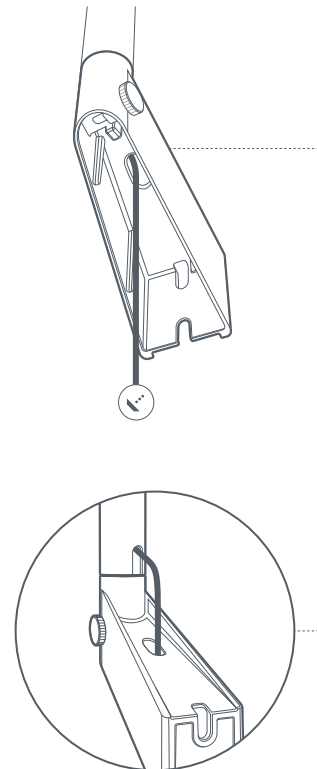

12 | Install Cover

Install the cover and feed the cable through.
Connect the Starlink cable to the Advanced Power
Supply then connect to power.

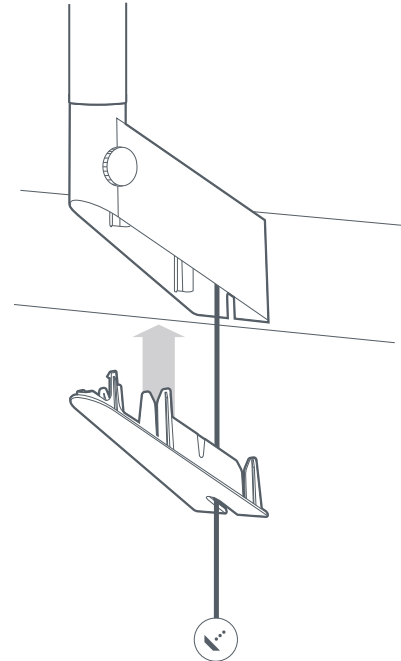

13 | Align and Lock Your Starlink

An alert on the App will show if you need to rotate
Starlink to be properly aligned.

Click the alert to use the alignment tool. Once
aligned, tighten the thumb-screw on the mast to
prevent rotation

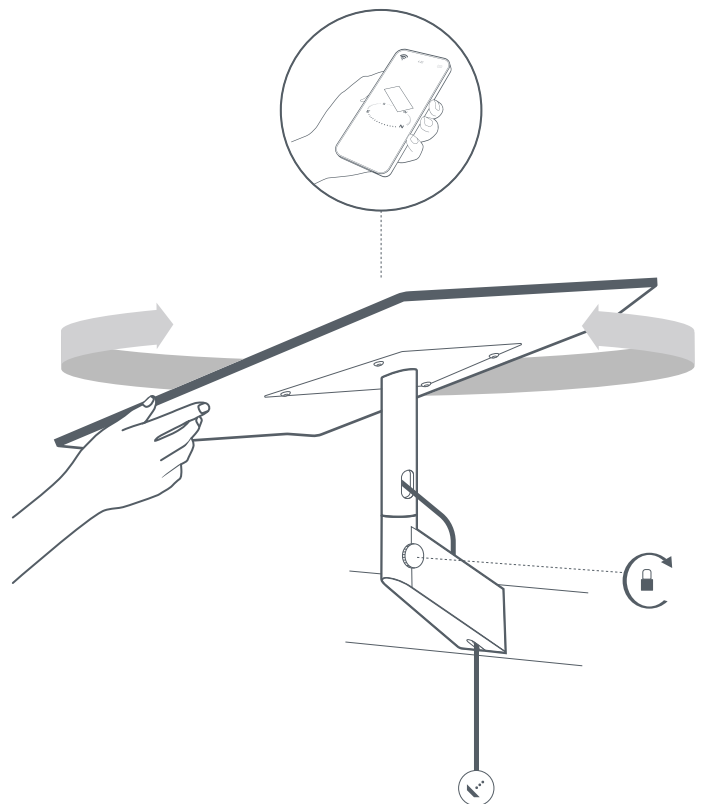

INSTALLATION CONDITIONS

⚠**CAUTION!** If you are uncomfortable with any part of the installation process, do not attempt - contact a professional to install your Starlink. Starlink is not responsible for injury or damage to property caused by the installation process.

Kit Installation for Use on Moving Vehicles.

⚠**CAUTION!** Take extra care if installing a Starlink for being used on a moving vehicle or vessel. Ensure that the mount is installed firmly on a structurally sound, horizontal surface away from other equipment to give your Starlink a clear view of the sky. Equipment falling off the vehicle due to poor installation practices can cause serious accidents resulting in bodily injury, do not mount the Starlink on any vehicle or vessel if the mount structure is not stable, or if it cannot be properly secured as described in this guide. Ensure the installation on vehicle or vessel is compliant with local Department of Transportation or maritime regulations.

⚠**WARNING!** Mounts are not designed for high winds, hurricane or tornado wind loads. Tethering should be used in all cases to prevent failure in an unexpected wind event. See installation instructions before connecting this equipment to the input supply.

⚠**WARNING!** To avoid personal injury and/or damage to the property when drilling, take caution and follow basic safety procedures, including:

- Wear appropriate eye, hand, and face protection.
- Avoid studs, electrical wiring, and water lines when drilling. Drilling into any of these can lead to fire, shock, injury, or death.
- Drill at a slight downward angle from the home interior to the home exterior and thoroughly apply sealant. Improper drilling and sealing may lead to water and/or bug intrusion and/or damage.