

STARLINK | PERFORMANCE PIPE ADAPTER

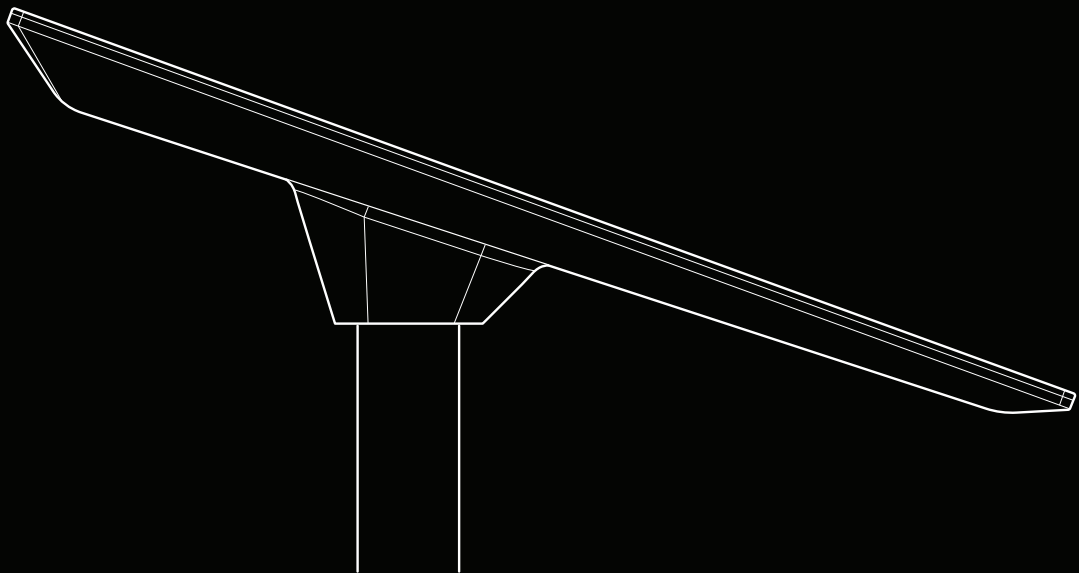

What's in the Box

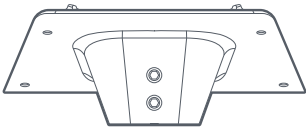

Pipe Adapter Mount



M6 Button Head Screws
(4x)



Hex Key
(2x)

99 mm
(3.9 in)

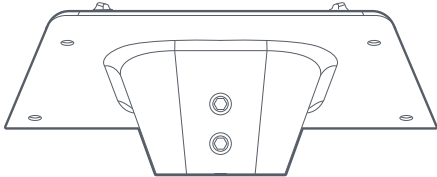

252 mm
(9.9 in)

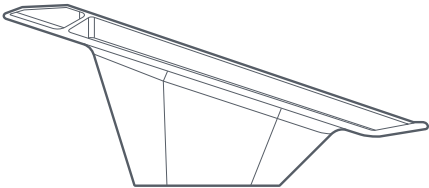

233 mm
(9.2 in)

218 mm
(8.6 in)

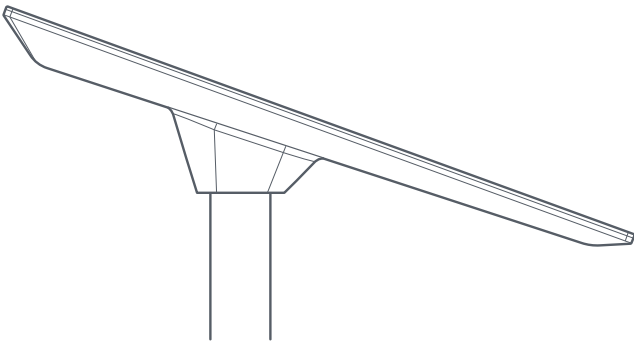

38-60 mm
(1.5 - 2.4 in)

1 | Download the Starlink App

Scan the QR code to download the Starlink App.

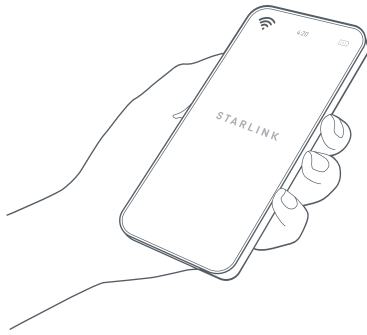

2 | Plug in Starlink Cable

Align the Performance connector end of the Starlink cable indicated by the red notch and plug into your Starlink by holding the end of the plug and firmly inserting into the dish.

If the Starlink cable needs to be removed, rotate the collar counterclockwise and pull to disconnect from your Starlink.

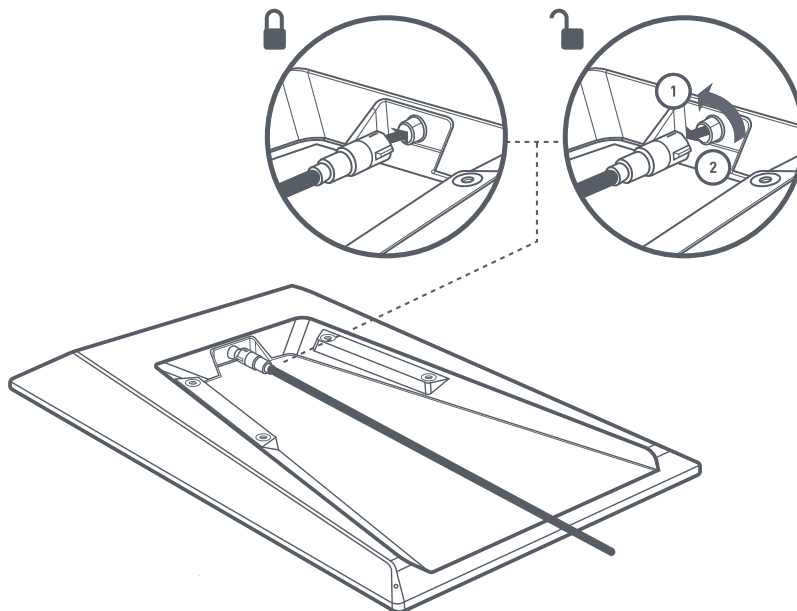

3 | Install Pipe Adapter Onto Starlink

Install the provided machine screws through the pipe adapter into the back of the Starlink and tighten the four screws using the hex key. Tighten screws in all 4 corners until bolts reach 7 N-m (5.2 lb-ft). Ensure the mount is firmly attached to the Starlink.

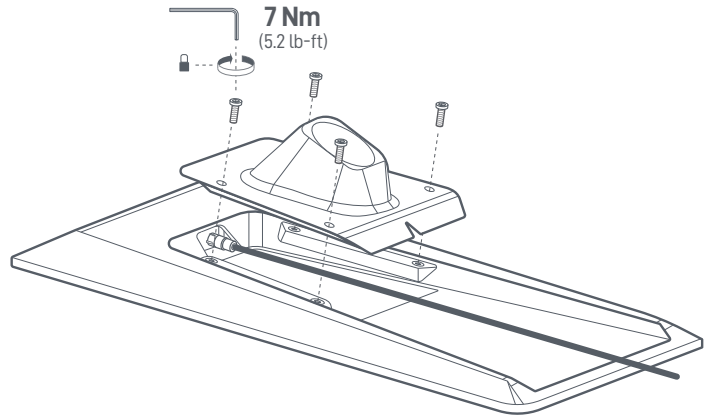

4 | Loosen Attachment Screws

Using the hex key, loosen the attachment screws in the Pipe Adapter until the opening is large enough to fit your mounting pipe.

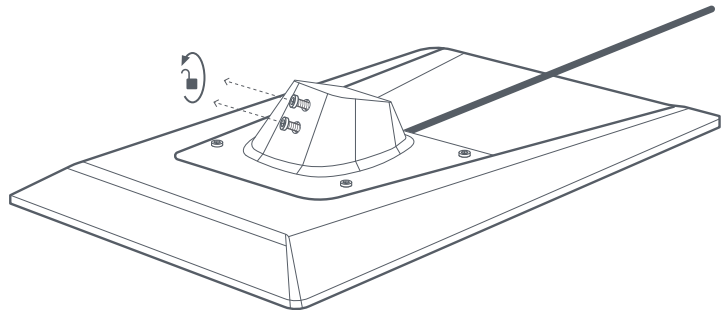

5 | Mount Starlink to Pipe

Slide the Pipe Adapter onto your mounting pipe. Temporarily tighten the attachment screws to stabilize Starlink onto pipe.

Connect the other end of the Starlink cable to the power supply and plug it into power outlet.

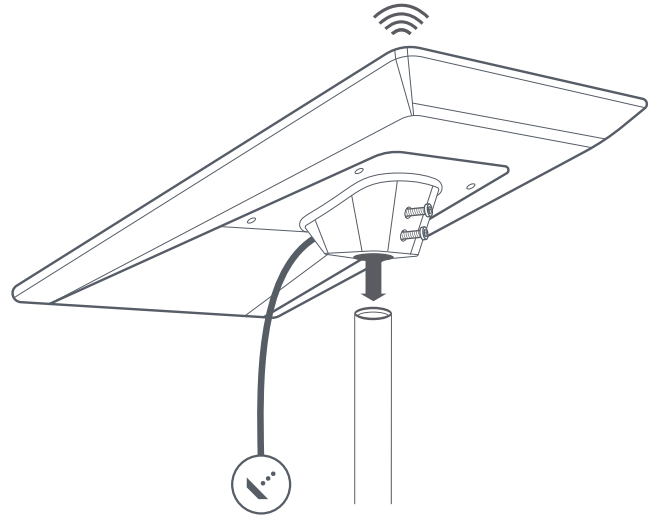

6 | Align Your Starlink

An alert on the App will show if you need to rotate Starlink to be properly aligned.

Click the alert to use the alignment tool.

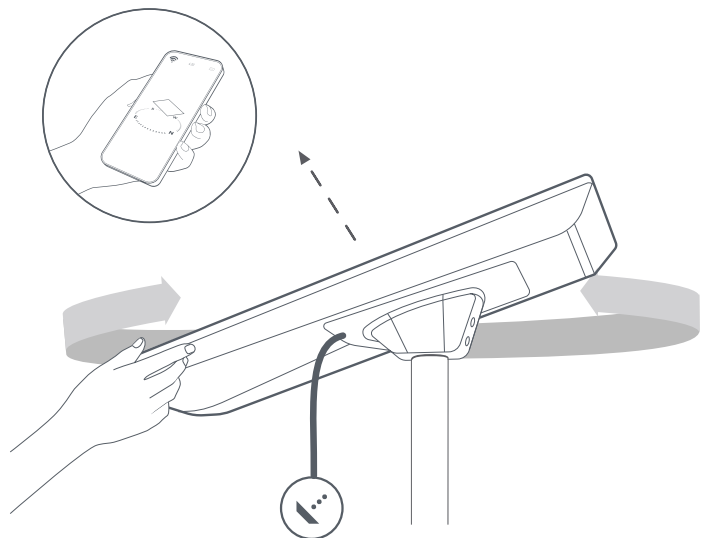

7 | Lock Alignment

Using the hex key, tighten the attachment screws on the Pipe Adapter to lock your Starlink in place.

Ensure your Starlink is firmly attached.

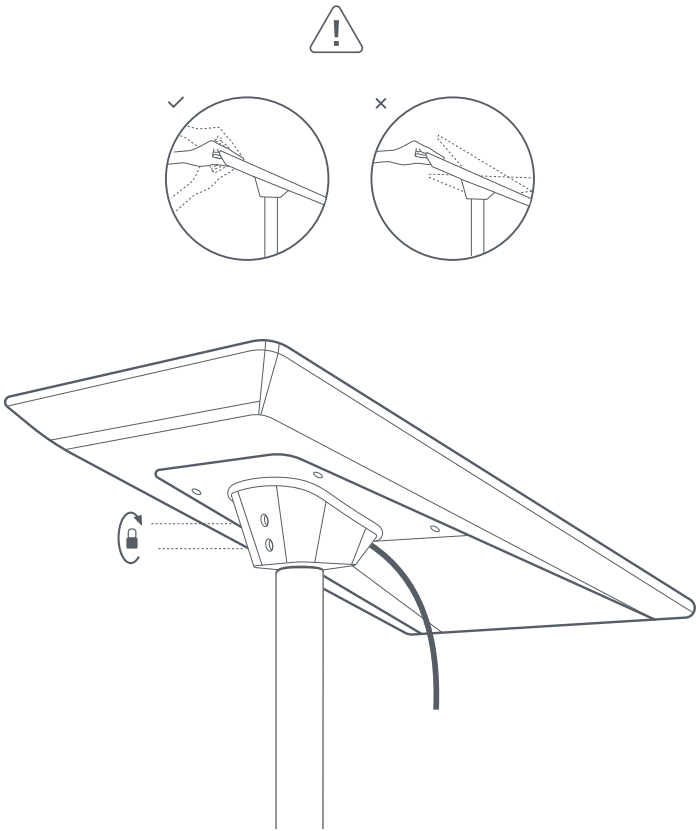

INSTALLATION CONDITIONS

⚠**CAUTION!** If you are uncomfortable with any part of the installation process, do not attempt - contact a professional to install your Starlink. Starlink is not responsible for injury or damage to property caused by the installation process.

Kit Installation for Use on Moving Vehicles.

⚠**CAUTION!** Take extra care if installing a Starlink for being used on a moving vehicle or vessel. Ensure that the mount is installed firmly on a structurally sound, horizontal surface away from other equipment to give your Starlink a clear view of the sky. Equipment falling off the vehicle due to poor installation practices can cause serious accidents resulting in bodily injury, do not mount the Starlink on any vehicle or vessel if the mount structure is not stable, or if it cannot be properly secured as described in this guide. Ensure the installation on vehicle or vessel is compliant with local Department of Transportation or maritime regulations.

⚠**WARNING!** Mounts are not designed for high winds, hurricane or tornado wind loads. Tethering should be used in all cases to prevent failure in an unexpected wind event. See installation instructions before connecting this equipment to the input supply.

⚠**WARNING!** To avoid personal injury and/or damage to the property when drilling, take caution and follow basic safety procedures, including:

- Wear appropriate eye, hand, and face protection.
- Avoid studs, electrical wiring, and water lines when drilling. Drilling into any of these can lead to fire, shock, injury, or death.
- Drill at a slight downward angle from the home interior to the home exterior and thoroughly apply sealant. Improper drilling and sealing may lead to water and/or bug intrusion and/or damage.